

ALDERTON PARK #10 ALDERTON DRIVE

SOLD



Your lifestyle awaits...

LAND AREA - 1275 M2 + DECKING - 44 M2
 TOTAL FLOOR AREA - 272 M2 + COVERED OUTDOOR AREA - 36 M2
 (INCL. GARAGE - 38 M2) + COURTYARD AREA - 31 M2

This photo is of the stunning view seen from the living area & master bedroom. This beautiful, substantial home designed by award winning Avery Team Architects, has all day sunshine, multiple entertaining areas & a glimpse of the coast!

Consisting of 4 large bedrooms, 3 bathrooms, 2 spacious living areas & an office. The lounge & family room open out onto the fantastic courtyard that basks in the evening sun & is equipped with an outdoor fire & infra-red heaters making it enjoyable all year round. Complete with exquisite Danish wooden floors, quality fittings & finish & a spacious kitchen. The solid concrete construction & high ceiling stud also add to the grandness.

A quick walk to school & close to the shops, cafes & work...
 This home is the ultimate living for a modern family.

THE ALDERTON PARK DESIGN AND BUILD PROCESS IS EASY AND ENJOYABLE. WE HAVE A NUMBER OF HOMES SUCH AS THIS WHICH ARE AVAILABLE NOW. ALTERNATIVELY, WE DISCUSS YOUR REQUIREMENTS AND DESIRED POSITION IN THE PARK - HOME CONCEPTS ARE THEN DEVELOPED BY ONE OF OUR ARCHITECTS AND PRESENTED TO YOU. THE DETAILS OF YOUR HOME ARE REFINED, TIME FRAMES ARE SET, A PRICE IS AGREED AND WE TAKE CARE OF THE REST.

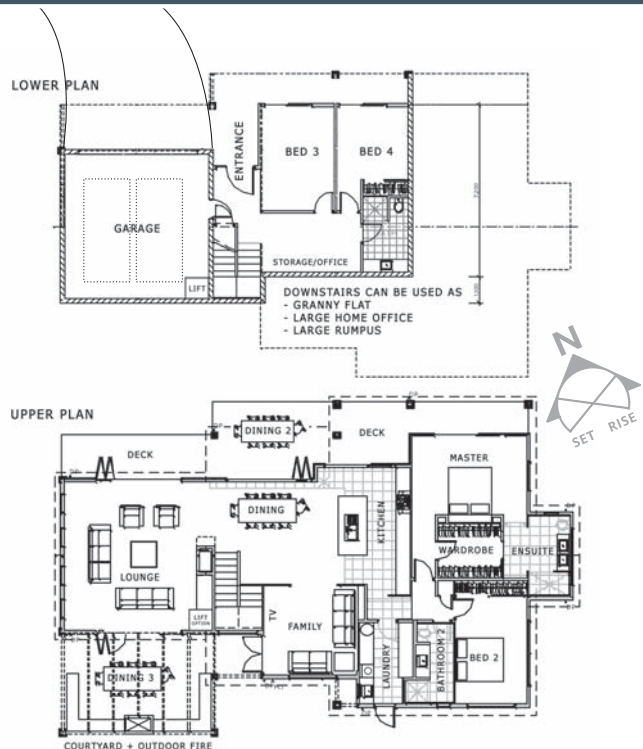

0800 ALDERTON (25 33 78)

WWW.ALDERTONPARK.CO.NZ

EXCLUSIVELY MARKETING BY **HARVEYS**